

777

PISTON SEAL

*Double-Acting
Polyurethane Face with Rubber Energiser*

DESIGN

The Hallite 777 double-acting, energised piston seal is a compact seal for medium to heavy-duty applications designed to fit a range of industry standard grooves making it ideal for retrofitting existing products. Our metric part range will fit ISO 7425-1 standard type housings and our inch parts will typically fit standard industry grooves.

The seal's geometry provides fluid reservoir between the primary sealing lips which reduces breakaway and running friction.

The Hallite 777 is comprised of a tough, wear-resistant thermoplastic elastomer face seal pre-loaded with a square or rectangular cross-section NBR energiser depending on the groove proportions. The square or rectangular energiser provides an equal load on the seal face while also providing improved stability over a conventional O-ring energiser. This design allows this seal to be used in smaller grooves without compromising the performance of the sealing system.

The standard face material for the Hallite 777 is Hythane® 723, one of Hallite's high temperature polyurethanes (HTPU). Additional material options are available. The energiser material comes in a number of material options to extend operating conditions. Contact your local Hallite technical team to decide which is best for your application.

We recommend that an adequate bearing, such as the Hallite 506 or 87 bearing strip or the Hallite 533 moulded bearing, is mounted on one or both sides of the seal. For further details of bearing grooves, please refer to the appropriate product data sheet.



FEATURES

- High temperature and pressure capabilities
- Fits common industry housings
- Resists rolling and twisting in long stroke applications
- Low operating friction level
- Strong abrasion resistance
- Easy to install
- Positive load holding capabilities
- Ideal for use with Hallite 506, 533, or 87 bearing

PART NUMBER STRUCTURE

777M00400JB01

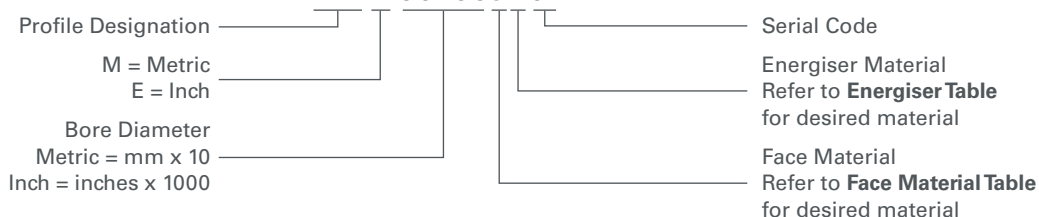

WWW.HALLITE.COM

MATERIALS

As standard, this product comes in the following face material. Contact your local Hallite technical team if you would like to find out if this profile can be made in a custom material to suit your application. Use the part designator in the table below to specify material choice when ordering. For further material details, please refer to the Hallite MaterialTable.

MATERIAL OPTIONS	Name	Face Type	Face Colour	Part Designator
Standard	Hythane® 723	TPU	Purple	J
Optional - Inch Only	Hythane® 593	TPU	Grey	K

This product comes in a number of energiser material options to extend operating conditions. Contact your local Hallite technical team to decide which is best for your application. Use the part designator in the table below to specify material choice when ordering. For further material details, please refer to the Hallite MaterialTable.

MATERIAL OPTIONS	Name	Energiser Type	Energiser Colour	Part Designator
Standard	Nitrile 75°	NBR	Black	B
Optional	Custom FKM	FKM	Black	V
Optional	Custom	Custom	Custom	X

TECHNICAL DETAILS

OPERATING CONDITIONS	METRIC	INCH
Maximum Speed	0.5 m/sec	1.5 ft/sec
Temperature Range	-40°C +130°C	-40°F +265°F
Maximum Pressure	400 bar	5800 psi

NOTE

Data given are maximum values and can apply depending on specific application. Maximum ratings of temperature, pressure, or operating speeds are dependent on fluid medium, surface, gap value, and other variables such as dynamic or static service. Maximum values are not intended for use together at the same time, e.g. max temperature and max pressure. Please contact your Hallite technical representative for application support.

MAXIMUM EXTRUSION GAP				
Pressure bar	100	165	260	400
Max Gap mm	0.75	0.65	0.50	0.25
Pressure psi	1500	2400	3750	5800
Maximum Gap in	0.030	0.025	0.020	0.010

NOTE

This product can perform at pressures over 400 bar subject to discussion with local technical representative and application.

NOTE

Figures show the maximum permissible gap all on one side using maximum bore Ø and minimum piston Ø. Refer to Housing Design section.

SURFACE ROUGHNESS	µmRa	µmRz	µmRt	µinRa	µinRz	µinRt
Dynamic Sealing Face ØD ₁	0.1 - 0.4	1.6 max	4 max	4 - 16	63 max	157 max
Static Sealing Face Ød ₁	1.6 max	6.3 max	10 max	63 max	250 max	394 max
Static Housing Faces L ₁	3.2 max	10 max	16 max	125 max	394 max	630 max

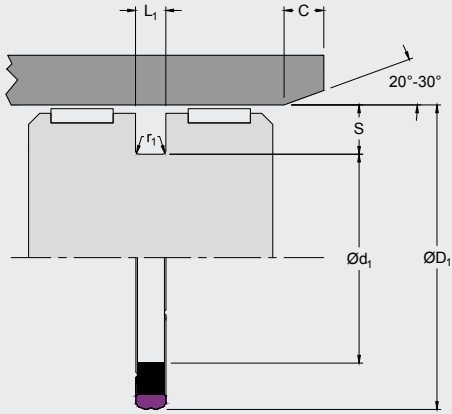

PISTON SEAL

Double-Acting
Polyurethane Face with Rubber Energiser

TECHNICAL DETAILS CONTINUED

CHAMFERS & RADII				
Groove Section ≤ S mm	3.75	5.50	7.75	10.50
Min Chamfer C mm	2.00	2.50	5.00	5.00
Max Fillet Rad r ₁ mm	0.40	0.80	1.20	1.60
Groove Section ≤ S in	0.150	0.220	0.310	0.410
Min Chamfer C in	0.080	0.100	0.200	0.200
Max Fillet Rad r ₁ in	0.016	0.032	0.047	0.063

TOLERANCES	ØD ₁	Ød ₁	L ₁
mm	H9	h9	+0.20-0
in	H9	h9	+0.008 -0



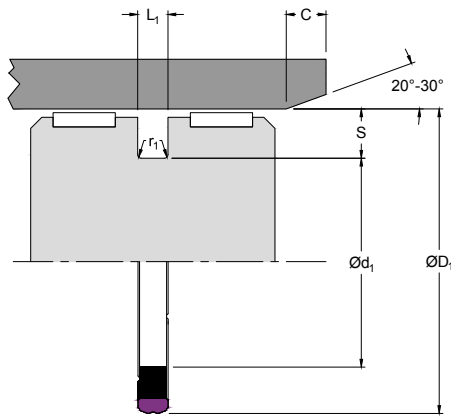

777

PISTON SEAL

*Double-Acting
Polyurethane Face with Rubber Energiser*

PART NUMBER RANGE

METRIC					
ØD ₁	TOL H9	Ød ₁	TOL h9	L ₁ +0.20-0	PART No.
40.00	+0.06 +0.00	24.50	0.00 -0.05	6.30	777M00400JB01
50.00	+0.06 +0.00	39.00	0.00 -0.05	4.20	777M00500JB01‡
60.00	+0.06 +0.00	44.50	0.00 -0.06	6.30	777M00600JB01‡
65.00	+0.06 +0.00	49.50	0.00 -0.06	6.30	777M00650JB01
70.00	+0.06 +0.00	59.00	0.00 -0.07	4.20	777M00700JB01
70.00	+0.07 +0.00	54.50	0.00 -0.07	6.30	777M00700JB02
75.00	+0.07 +0.00	59.50	0.00 -0.07	6.30	777M00750JB01
80.00	+0.07 +0.00	64.50	0.00 -0.07	6.30	777M00800JB01‡
90.00	+0.09 +0.00	74.50	0.00 -0.07	6.30	77M00900JB01
100.00	+0.09 +0.00	79.00	0.00 -0.07	8.10	777M01000JB01
110.00	+0.09 +0.00	89.00	0.00 -0.09	8.10	777M01100JB01
120.00	+0.09 +0.00	99.00	0.00 -0.09	8.10	777M01200JB01
130.00	+0.10 +0.00	109.00	0.00 -0.09	8.10	777M01300JB01
140.00	+0.10 +0.00	119.00	0.00 -0.09	8.10	777M01400JB01
140.00	+0.10 +0.00	119.00	0.00 -0.09	10.50	777M01400JB02
160.00	+0.10 +0.00	139.00	0.00 -0.09	8.10	777M01600JB01‡

NOTE

Part numbers suffixed by "‡" indicate housing sizes to meet ISO 7425-1.